

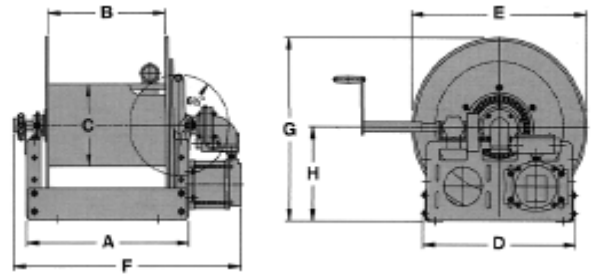

Explosion-proof electric or manual rewind reels

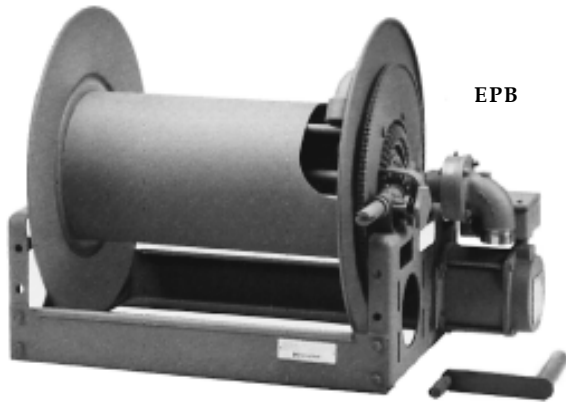

Series EPB and PB

These explosion-proof reels are available in either electric or manual rewind. They can be used individually or in pairs for liquid and vapor return hoses.

Item#	List	Description
EPBGMT*	\$3738.00	Electric Reel

**Call for quotation on reels with other options.*

Reel parts and accessories

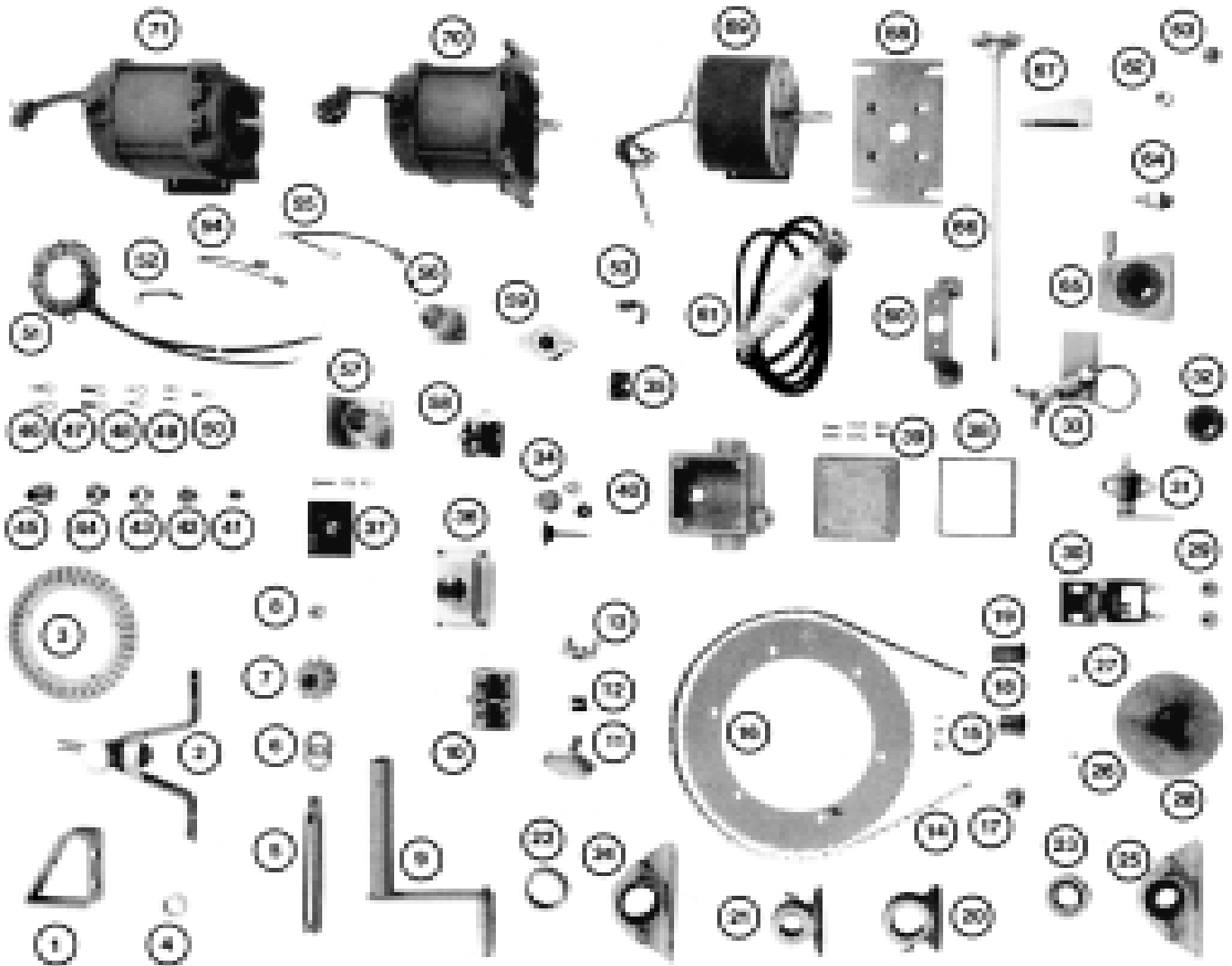

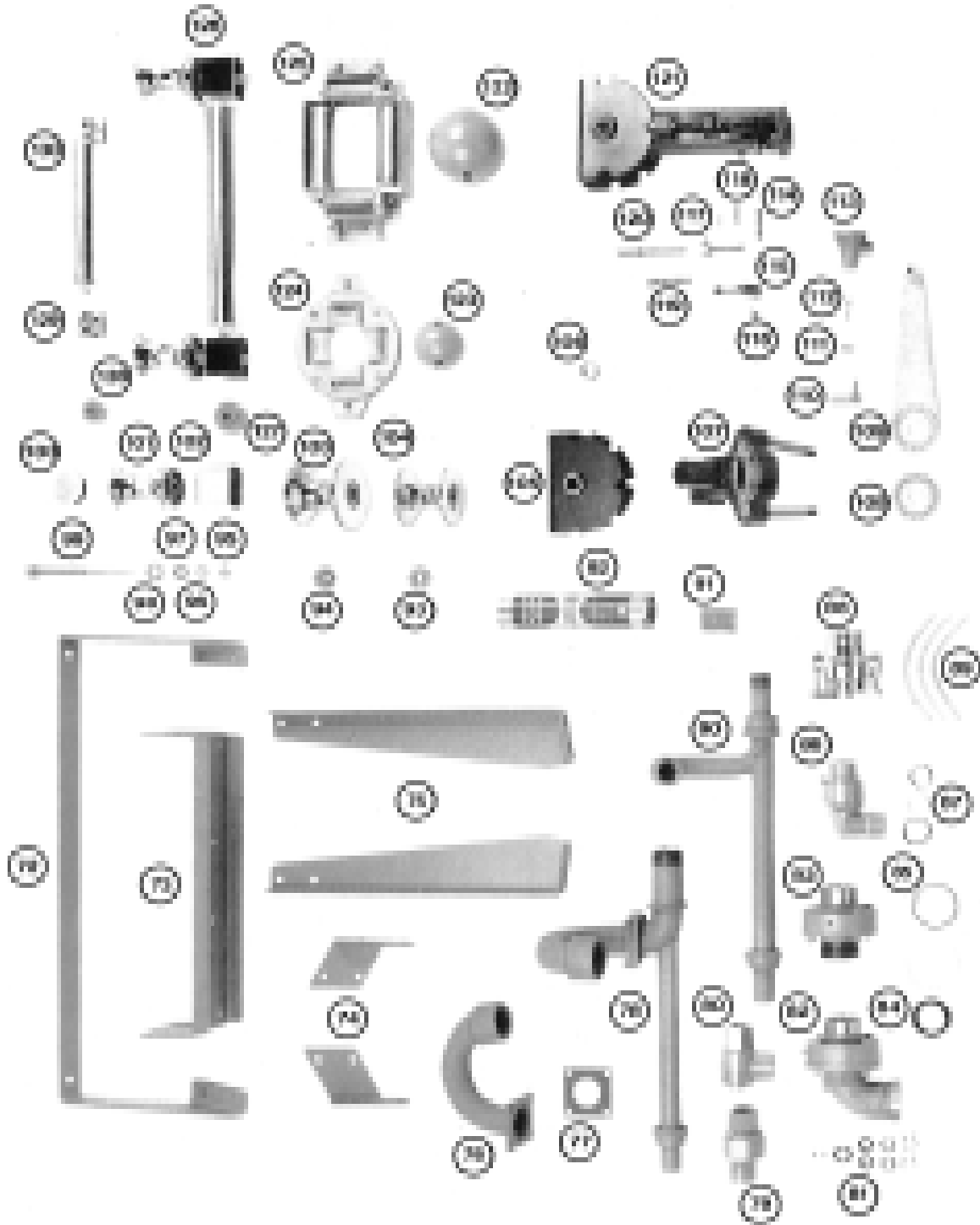
Reel parts and accessories -- continued

No.	Part #	Description	No.	Part #	Description
1	9914.0541	30° rewind bracket	13	9914.0433	H-3 brake pad
2	9914.0222	Complete vertical rewind assembly	14	9912.0001	Length #35 chain
3	9914.0372	H-26 ring gear	15	9912.0010	Connecting link (#35 chain)
4	9914.0351	Pinion Shaft collar with set screw	16	9910.1423	138T35 disc sprocket
5	9914.0261	Pinion shaft	17	9910.1116	11T35 motor sprocket 3/4"
6	9954.0003	Special spacer washer	18	9910.1118	11T35 motor sprocket 1-5/16"
7	9914.0393	H-27 pinion gear	19	9910.1119	11T35 motor sprocket 1 3/4"
8	9904.5600	5/8" hex nut	20	9902.2100	H-4B 1 1/2" bronze bearing
9	9914.0011	H-18 hand crank	21	9902.2000	H-41B 1" bronze bearing
10	9914.0243	H-2A pinion shaft bearing	22	9902.1700	1 1/2" bronze bearing insert
11	9914.0413	H-30A brake wheel	23	9902.1500	1" ball bearing insert
12	9914.0451	H-31 brake spring	24	9902.1600	1 1/2" S.A. bearing complete

No.	Part #	Description			
25	9902.1400	1" S.A. ball bearing complete	75	9945.0037	Top wind bracket for guidemaster™
26	9916.0081	³ / ₁₆ " x ⁵ / ₈ " key for explosion-proof motor shaft	76	9901.3760	1½" FIPT flanged riser
27	9916.0080	³ / ₁₆ " x ³ / ₄ " key for explosion-proof motor shaft	77	9965.0021	H-150G gasket for 1½" riser
28	9910.2219	Disc & sprocket for caliper brake (@#35 chain)	78	9901.3240	1½" hub assembly complete with riser (specify model)
28A	9910.2119	Disc & sprocket for caliper brake (@#41 chain)	79	9929.2573	1" straight Aeroquip (full flow) FxF 5900-20
29	9947.0024	Pair of brake pads for caliper brake(air)	80	9929.2588	1" 90° Barco FxF (balanced pressure)
30	9947.0020	Caliper brake air	81		Barco repair kit (specify size)
30A	9947.0001	Caliper brake manual	82	9930.0531	1½" 90° Hannay ball bearing swivel FxF & Victaculic (HJ1590JT)
31	9965.0030	PL-1 pinlock	83	9930.4610	1½" straight Hannay ball bearing swivel FxF & Victaculic (HJ1590JT)
32	9947.0038	Comet brake iron hub	84	9936.0640	PK-1 packing with nylon washer
33	9947.0035	Comet Brake Assembly (friction brake)	85	9938.0017	HJB-1 ball bearing assembly for Hannay swivel
34		Red dot repair kit	86	9929.1521	1" 90° Aeroquip (full flow) FxF 5900-30
35	9917.0014	Internal switch for EXPB-2A	87	9936.0510	Seal kit for 5900 series swivel FF028-16-01 (Buna-N)
36	9917.0001	EXPB-2A switch	88A	9930.5730	1½" straight Hannay packing joint H-5 (Victaulic)
37	9917.0037	Terminal block with mounting screw	88B	9930.5003	1½" straight Hannay packing joint H-5 (Threaded)
38	9917.0034	Junction box gasket	89	9936.0659	H-5C packing seal for H-5 (ring type)
39	9917.0033	Junction box cover iwth mounting screw	90	9901.1600	1" hub assembly complete (specify model number)
40	9917.0032	Junction box	91		Set of stainless steel balls (specify size & make of swivel)
41	9917.0119	PLG-1½" plug	92	9938.0051	14 oz. tube Hannay grease
42	9917.0120	PLG-2¾" plug	93	9945.0026	GM-608 ball bearing for GM-609
43	9917.0115	RE-31 reducing bushing	94	9945.0044	GM-108 ball bearing for GM-109 roller
44	9917.0116	RE-32 reducing bushing	95	9940.0011	⁷ / ₁₆ " hex nut
45	9955.0006	½" strain relief connector	96	9954.0029	⁷ / ₁₆ " lock washer
46	9917.0080	#4 motor terminals for ⁵ / ₁₆ " stud	97	9940.0014	⁷ / ₁₆ " nylon washer
47	9917.0081	#8 motor terminals for ³ / ₈ " stud	98	9954.0009	⁷ / ₁₆ " flat washer
48	9917.0093	#10 ⁵ / ₁₆ " terminals	99	9940.0012	FH-307 delrin-over-steel step bolt
49	9917.0091	#14 16 -10 terminals	100	9940.0004	FH-309 chrome snap cap
50		#14 16- ⁵ / ₁₆ terminals	101	9940.0005	FH-301 spool
51	9916.0013	Brush board assembly (with springs and brushes) for permanent magnet motor	102	9940.0006	FH-302 block
52	9916.0071	572008 brushes (pair) for permanent magnet non-explosion-proof motor (imperial)	103	9945.0043	GM-109 roller with GM-108 bearing
53	9916.0075	SA678-9 brush for field-wound motor	104	9945.0019	GM-109 roller with GM-608 bearing
54		D-50197A brushes (pair) for permanent magnet non-explosion-proof motor (Imperial)	105	9945.0009	GM-611 mounting yoke
55	9916.0070	57200 brushes (pair) for permanent magnet motor (imperial)	106	9945.0011	GM-616 bronze bushing
56	9917.0019	ESH-2B guidemaster™ mounting bracket for EPS-1	107	9945.0001	GM-610A roller body with roller mounting bolts
57	9917.0018	ESH-2A universal mounting bracket for EPS-1	108	9951.0009	GR-4A guide arm positioner
58	9917.0027	12V solenoid	109	9951.0010	GR-4 guide arm
59		CDLM circuit breaker (specify amperage)	110	9951.0006	GR-658 pawl and pin
60	9917.0026	CB-1 mounting bracket	111	9951.0017	Spring E 360037-1250S
61	9917.0003	EPS-1 switch with 6' cord	112	9951.0018	Cotter pin
62	9917.0007	83274 chrome recessed cap for 90018 switch	113	9951.0012	GR-5 cable guide (bronze scoop)
63	9917.0008	83280 rubber cover for 90018 & EPS-1	114	9945.0021	Pivot bolt ¼-20
64	9917.0006	90018 switckh, less cap	115	9945.0016	Positioning lever
65	9947.0045	EH-20 bearing and brake assembly	116	9945.0022	Nut for pivot bolt ¼-20
66	9947.0051	EH-820 rod and handle	117	9945.0008	Linkage and pin
67	9947.0050	EH-820 rod support	118	9945.0023	Positioning lever pin
68	9916.0090	Flange mount plate for 12V non-explosion-proof motor	119	9945.0006	Compression spring
69	9915.0052	12V base mount non-explosion-proof motor	120	9945.0005	Positioning bolt
70	9915.0003	12V flange mount explosion-proof motor	121	9944.0012	Guide arm body with locking mechanism and mounting yoke
71	9915.0014	12V base mount explosion-proof motor	122	9922.0012	HS-45 hose stop (specify O.D. of hose)
72	Specify model	Top wind mounting bracket for FH-3	123	9922.0011	HS-3 hose stop (specify O.D. of hose)
73	9945.0035	Cross member bracket for guidemaster™	124	9939.0003	EH-714 roller assembly
74	9945.0036	Bottom wind brackets for guidemaster™	125	9939.0007	EH-678 roller assembly
			126	9939.0042	FH-3 roller and spool assembly (specify model number of reel)
			127	9940.0008	FH-303-2 trunnion bearing
			128	9940.0007	FH-303-15 trunnion bearing
			129	9940.0001	EH-650 mounting block
			130	9939.0060	Utility hose roller assembly A (specify length)